

REVISIONES				
Rev.	Symbol	Modification N°	Date	Name

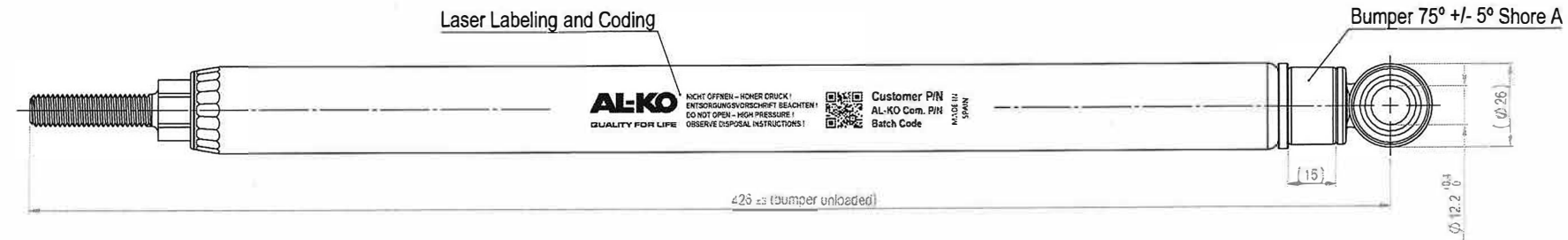
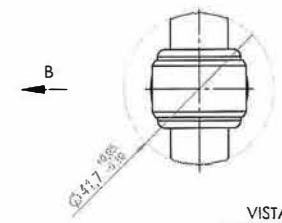
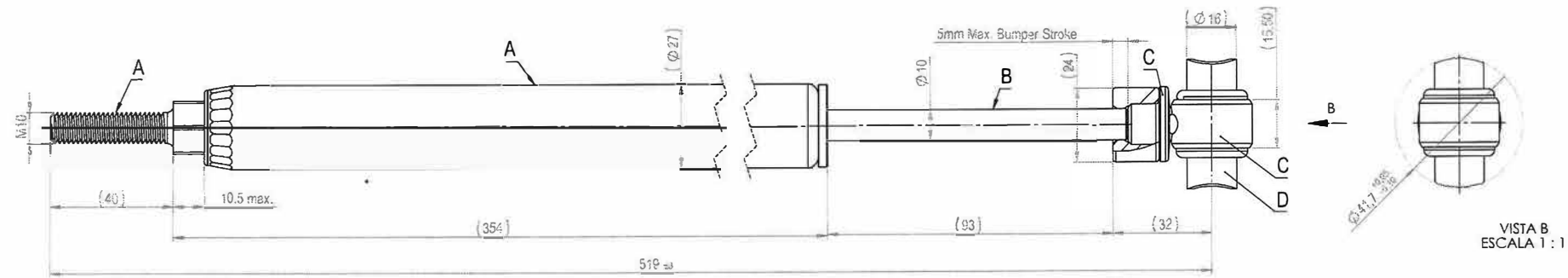

General Information	
* Customer:	AL-KO
Supply conditions:	
* Supply length:	extended
* Delivery unpreserved:	
* Mounting parts:	free of paint
Permitted working / assembly conditions:	
* Permitted working temperature:	-30°C ... +85°C
Design Specifications:	
* Rebound stop	Not to be used as stroke limitation
* Endurance and functional test acc. to Standard:	WN 9.830.14
* Static load resistance:	N/A
* Marking acc. to AL-KO Standard:	20060701
* Marking acc. to drawing:	0128 (QR optional)
Protection against Corrosion	
* Finish A: Painted acc. to AL-KO Standard:	20110704 / f
* Finish B: Oxinitrided, alternatively chromium-plated acc. to AL-KO Standard:	20200406 / 4 (Oxinitrided) 20201105 / 5.3 (Chromium-plated)
* Finish C: Fe//Zn8//C (Free Cr+6)	EN ISO 2081
* Finish D: Fe//Zn12//A (Free Cr+6)	EN ISO 2081
Visual aspects:	
* Outertube, painted	RAL 9011, black
Recycling:	
* According to AL-KO Standard:	WN 70001

AL-KO
ALLOIS KOBER GmbH
Ichenhauser Str. 14
D-89359 Kötzing

Document checked and approved.

Florian Propp
p.p.
(Signature)

Velocity	[mm/s]	85
Extension	[N]	3610
		4330 2830
Compression	[N]	865
		1040 690
Response Threshold Ka v = 10mm/s	[N]	490
		590 380
Gas Forces (5mm from extended length)	[N]	From 110 to 220
Test Temperature	[°C]	20 ± 5

This plate is founded on a confidential basis subject to return upon demand by AL-KO and nothing herein may be reproduced, used or disclosed in whole or in part without the prior written permission of AL-KO.

- All machined inside corners 0.8 mm radius.
- Break all sharp edges.
- Remove all burrs, fins, flash and projections.
- General Tolerances acc. to ISO 2768 - m

Dimensionally deviations for basic size range

Size	mm	mm	mm
0.5	5	30	120
0.5 to 5	5 to 30	30 to 120	120 to 400
± 0.1	± 0.2	± 0.3	± 0.5

Tolerancing: ISO 8915
 General Tolerances: Metal acc. to ISO 2768, Rubber acc. to DIN 7715, Plastic acc. to DIN 18201
 Scale: 1:5
 Weight (g): 653.67
 Finish: Finish
 Date: 06/02/2023
 Name: jon.lauckha
 Description: Amt. M (E10) 1540522
 Sheet format size: A2
 Project N°: 7104
 Page: 1 of 1
 Alternative Ref.: 1540522
 Superseeder Ref.: N/A
AL-KO
 Circa Durango-Elvado, N° 25
 42270 Abadano, Spain